



### OVERVIEW

- ♦ A bold and sleek luminaire with superior performance. Enclosed and gasketed housing will withstand most critical environments. Weather and chemical resistant, corrosion free, and impervious to vapors, dust, and moisture.

### CONSTRUCTION

- ♦ Housing—Molded of one-piece impact resistant fiberglass reinforced polyester; self extinguishing, flame resistant and unaffected by many industrial chemicals
- ♦ Diffuser—One piece injection molded impact resistant linear ribbed acrylic lens.
- ♦ Heavy Gauge Steel-Wiring Tray—Tethered to housing, contains the ballast, sockets, and all wiring on an easy to handle one piece component. Unique metal locking devise system allows tray to hinge open or lock closed for easy one-person wiring connections. Tray is finished in baked white enamel with minimum reflectivity of 87%.
- ♦ Latches—Unbreakable polycarbonate with self-locking feature to stay closed without hardware. Optional tamperproof screws add maximum security against vandalism or unauthorized fixture entry. Stainless steel latches optional.

PROJECT \_\_\_\_\_

TYPE \_\_\_\_\_

QTY. \_\_\_\_\_

### APPLICATIONS

- ♦ Food Handling and Processing Facilities
- ♦ Refrigerated Storage
- ♦ Drug and Chemical Plants
- ♦ Shower Areas
- ♦ Parking Garages
- ♦ Pedestrian and Roadway Tunnels
- ♦ Outdoor Public Areas

### INSTALLATIONS

- ♦ Installations—A 7/8" hole in each end for surface conduit entry and continuous feeds. Liquid tight plugs supplied. Weatherproof hubs supplied by others. Mount individually or continuous. Optional stainless steel "slide grip" style hanger brackets allow easy mounting without drilling housing. Two top-side embossments contain drill points for job site mounting options. Proper sealing will maintain wet location status.

### ELECTRICAL

- ♦ All electrical components are UL or ETL Listed. Lamp holders provided ensure positive lamp retention.
- ♦ Sufficient knock-outs are provided for connections and through wiring.
- ♦ Electronic class P, thermally protected ballasts standard.
- ♦ Green ground screw installed in channel.
- ♦ All fixtures come equipped with ballast disconnect to meet NEC code 410.73.

### LISTINGS/QUALIFICATIONS

- ♦ ETL C/US
- ♦ IP65, IP66, IP67 Rated
- ♦ NSF Component
- ♦ RoHS Compliant
- ♦ High Pressure Hose Test
- ♦ NEMA 4X



### ORDERING GUIDE

Fill in the boxes below with the corresponding **bold** options.

Example: **VT401-4-2-32-T8-B8IN-MV**

VT401		2				MV				
SERIES	FIXTURE LENGTH	NO. OF LAMPS	WATTAGE	LAMP TYPE	BALLAST TYPE	VOLTAGE	OPTIONS			
VT401	T8						EM1	Emergency Battery Back Up, 1 Lamp Operation		
	4   4FT.	2	32	T8	B8IN	MV	EM2	Emergency Battery Back Up, 2 Lamp Operation		
	8   8FT.	2	32-TAN	T8	B8IN	MV	2C	2 Circuit		
	T5 / T5HO						DIM	Dimming—Consult Factory		
	4   4FT.	2	54	T5HO	B5HOP	MV	M7	Infrared Occupancy On/Off Sensor, Weather Proof - Externally Mounted		
	8   8FT.	2	54-TAN	T5HO	B5HOP	MV	Optical Reflector (optional)			
							MRT	Miro-4 Enhanced Specular Aluminum Reflector. 95% Reflectivity		
							Accessories			
							TP	Polycarbonate Tamper-proof Latches w/ screws		
							TS	Stainless Steel Tamper-proof Latches w/ screws		
							MB	Mounting Brackets (Set)		

Consult Factory for additional configurations and options not listed or shown.

Ballast

B8IN T8, Instant Start NBF (Standard)

Consult Factory for additional configurations and options not listed or shown.

#### Ballast

**B8IN** T8, Instant Start NBF (Standard)

**B5HOP** T5 HO, Program Start

#### Voltage

**MV** 120-277V

Note:

**TAN**—Tandem Units, double the number of lamps

For T5/T5HO Fixtures—

T8/T5 Conversion Sockets are used to meet fixture length

### DIMENSIONS

END VIEW

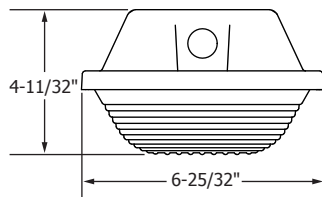

Length	
Nominal	Length
4FT.	51-21/32"
8FT.	100"

TOP VIEW

