

OVERVIEW

- ♦ The TV320 provides a decorative appearance to any wall application with its round profile and smooth, white acrylic diffuser.

FEATURES

- ♦ Available in 2ft. and 4ft. sizes.
- ♦ CRI greater than 80.
- ♦ Rated Life [L70] — 50,000 Hours.
- ♦ Fixture lumens per watt ratios [LpW] — Greater than 100.
- ♦ Class P Universal driver, 120-277V (50/60Hz)
- ♦ 0-10V Dimming
- ♦ Ultrasonic Occupancy Motion Sensors

HOUSING

- ♦ Constructed from heavy-gauge cold rolled steel.
- ♦ Completed with a baked white finish with high reflectivity.
- ♦ Electrical knockouts are provided on the housing back and ends.

LENS

- ♦ Extruded smooth white acrylic lens. May be removed through the end caps.

PROJECT _____

TYPE _____

QTY. _____

APPLICATIONS

- ♦ Stairwells
- ♦ Bathrooms
- ♦ Corridors
- ♦ Low Traffic Areas

INSTALLATIONS

- ♦ Designed for surface mount on walls.
- ♦ Mount individually in any direction.
- ♦ Suitable for ceiling surface mount.

LED

- ♦ Small-scale diffuser evenly surrounds the LED light source.
- ♦ Linear arrayed LED modules produce a perfect combination of diffuse and effective illumination.
- ♦ Each board contains several precisely placed mid-power, high efficacy LEDs in a layout that replaces the need for supplemental heat sinking.
- ♦ The LED boards maximize optical efficiency by producing evenly diffused light.
- ♦ Dimming down to 1% on 0-10V dimming controls is standard.

WARRANTY

- ♦ 5 year limited warranty is standard.
- Exclusions may apply. Contact factory for terms and conditions.*

LISTINGS/QUALIFICATIONS

- ♦ ETL C/US
- ♦ ADA Compliant, less than 4" off wall.
- ♦ Damp Location
- ♦ Proudly Made in America



ORDERING GUIDE

Fill in the boxes below with the corresponding **bold** options.

Example: **TV320-4-32L-40K-U-D1**

TV320				U	D1			
SERIES	FIXTURE LENGTH	NOMINAL LUMENS	COLOR TEMP.	VOLTAGE	DIMMING	OPTIONS		
TV320	2 2FT. 4 4FT.	2FT. 22L 2200 32L 3200 41L 4100 4FT. 34L 3400 47L 4700 60L 6000 64L 6400 XXX XXXX Custom Lumen Package Contact Factory.	30K 3000K 35K 3500K 40K 4000K 50K 5000K	U 120-277V	D1 0-10V Dimming to 1%*			
						Emergency		
						E5 Emergency Battery Back-Up, 500 Lumens		
						E7 Emergency Battery Back-Up, 700 Lumens		
						E10 Emergency Battery Back-Up, 1000 Lumens		
						E13 Emergency Battery Back-Up, 1300 Lumens		
						Sensor		
						M1 Infrared Occupancy On/Off Sensor Externally Mounted		
						M3 Ultrasonic Occupancy On/Off Sensor Control		
						M4 Ultrasonic Occupancy Bi-level Sensor Control		
						M8 Infrared Occupancy Bi-level Sensor Externally Mounted		

*Compatible with 0-10V dimmers.

PHOTOMETRICS

Photometric reports are available at www.ullighting.net

DIMENSIONS

END VIEW

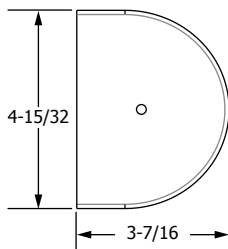

SIDE VIEW

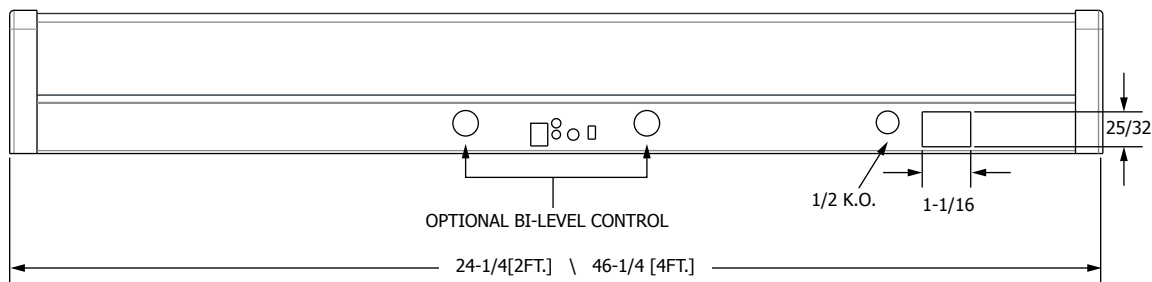

Shown with optional sensor **M3**



Shown with optional sensor **M4**

