



PROJECT
TYPE
QTY.



APPLICATION FEATURES

- ♦ Low profile linear T5 and T8 fluorescent luminaire featuring a crystal clear acrylic prismatic diffuser that wraps around the light source
- ♦ Shallow design
- ♦ Available with 2 or 4 lamps
- ♦ Available in lengths from 24 to 96 inches
- ♦ Clear, acrylic diffuser with prismatic bottom and ribbed linear sides
- ♦ Diffuser self-aligns and hinges from either side for easy re-lamping and re-ballasting
- ♦ Easy re-lamping and re-ballasting

CONSTRUCTION

- ♦ Housing—Fabricated from code grade cold rolled steel with ample bends for uniformity and strength. Design embossed end plates are riveted onto housing. Wireway cover snaps into housing for easy maintenance. Finished with a high quality white enamel paint baked on to provide an 87% minimum reflectivity.
- ♦ Diffusers—Extruded from 100% clear virgin acrylic plastic with an evenly spaced pattern of conical prisms on the bottom panel and sharp linear prisms on the interior side panels. Provides optimum brightness control and light transmission. Diffusers hinge down from either side for easy maintenance. All 8Ft. modules use two individual 4Ft. diffusers.
- ♦ Optional Diffusers—A .125" thick version of the standard diffuser or an acrylic smooth white version without prisms.
- ♦ Optional Diffuser Support—Lens may be supported by safety chains when being removed.
- ♦ Reflectors—Optical reflectors are CAD designed for optimal reflective performance.

APPLICATIONS

- ♦ Schools
- ♦ Hospitals
- ♦ Office Complexes
- ♦ Retail Locations
- ♦ Commercial Locations

MOUNTING

- ♦ Continuous row-mounting capability

ELECTRICAL

- ♦ All electrical components are UL or ETL Listed. Lamp holders provided ensure positive lamp retention.
- ♦ Sufficient knock-outs are provided for connections and through wiring.
- ♦ Electronic class P, thermally protected ballasts standard.
- ♦ Green ground screw installed in channel.
- ♦ All fixtures come equipped with ballast disconnect to meet NEC code 410.73.

APPROVALS

- ♦ ETL Listed. Suitable for dry and damp locations with ETL Damp Label.



ORDERING GUIDE

Fill in the boxes below with the corresponding **bold** options.

Example: **SM704-4-2-32-T8-B8IN-MV**

SM704						MV																			
SERIES	FIXTURE LENGTH	NO. OF LAMPS	WATTAGE	LAMP TYPE	BALLAST TYPE	VOLTAGE	OPTIONS																		
SM704	T8						<table border="1"> <tr><td>EM1</td><td>Emergency Battery Back Up, 1 Lamp Operation</td></tr> <tr><td>EM2</td><td>Emergency Battery Back Up, 2 Lamp Operation</td></tr> <tr><td>2C</td><td>2 Circuit</td></tr> <tr><td>DIM</td><td>Dimming—Consult Factory</td></tr> <tr><td>M1</td><td>Infrared Occupancy On/Off Sensor, Externally Mounted</td></tr> </table>					EM1	Emergency Battery Back Up, 1 Lamp Operation	EM2	Emergency Battery Back Up, 2 Lamp Operation	2C	2 Circuit	DIM	Dimming—Consult Factory	M1	Infrared Occupancy On/Off Sensor, Externally Mounted				
	EM1	Emergency Battery Back Up, 1 Lamp Operation																							
	EM2	Emergency Battery Back Up, 2 Lamp Operation																							
	2C	2 Circuit																							
	DIM	Dimming—Consult Factory																							
	M1	Infrared Occupancy On/Off Sensor, Externally Mounted																							
	2 2FT.	2 4	17	T8	B8IN	MV																			
	4 4FT.	2 4	32	T8	B8IN	MV																			
	8 8FT.	2 4	32-TAN	T8	B8IN	MV																			
	8 8FT.	2 4	59	T8	B8SI	MV																			
	T5 / T5HO						<table border="1"> <tr><td colspan="2">Ballast</td></tr> <tr><td>B8IN</td><td>T8, Instant Start NBF (Standard)</td></tr> <tr><td>B8SI</td><td>T8, Instant Start, Slimline</td></tr> <tr><td>B5P</td><td>T5, Program Start</td></tr> <tr><td>B5HOP</td><td>T5 HO, Program Start</td></tr> <tr><td colspan="2">Voltage</td></tr> <tr><td>MV</td><td>120-277V</td></tr> </table>					Ballast		B8IN	T8, Instant Start NBF (Standard)	B8SI	T8, Instant Start, Slimline	B5P	T5, Program Start	B5HOP	T5 HO, Program Start	Voltage		MV	120-277V
	Ballast																								
B8IN	T8, Instant Start NBF (Standard)																								
B8SI	T8, Instant Start, Slimline																								
B5P	T5, Program Start																								
B5HOP	T5 HO, Program Start																								
Voltage																									
MV	120-277V																								
4 4FT.	2 4	28	T5	B5P	MV																				
8 8FT.	2 4	28-TAN	T5	B5P	MV																				
4 4FT.	2 4	54	T5HO	B5HOP	MV																				
8 8FT.	2 4	54-TAN	T5HO	B5HOP	MV																				

Consult Factory for additional configurations and options not listed or shown.

Note:

TAN—Tandem Units, double the number of lamps

For T5/T5HO Fixtures—

T8/T5 Conversion Sockets are used to meet fixture length

DIMENSIONS

2 Lamps

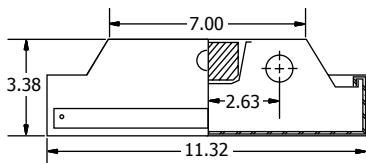

4 Lamps

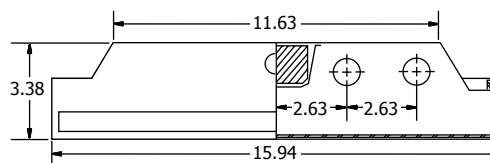

Back Views

