

### OVERVIEW

- ♦ Commercial grade high efficiency surface mounted fluorescent luminaire. This 1'x4', 2'x2' or 2'x4' module is available with various lamping and ballast combinations and options
- ♦ Welded steel housing with white enamel finish.
- ♦ Shallow design. Only 4" deep.
- ♦ Heavy duty construction.
- ♦ Clear, prismatic, acrylic diffuser.
- ♦ Hinges either side. Die formed steel pin hinges.
- ♦ Positive locking, cam action latches. Matching finish.
- ♦ Available with 2, 3, or 4 lamps.
- ♦ Uses T8, U6T8, and T5HO Lamps

### CONSTRUCTION

- ♦ Housing—Die formed code grade heavy gauge cold rolled steel with mitered ends welded into place for strength and uniformity. Snap-in type wireway cover allows for easy maintenance.
- ♦ Door Frames—Heavy gauge flush steel frame has mitered look corners and contains the specified diffusing media. Hinges down from either side of the housing or may be completely removed. Two positive action cam latches hold the frame closed. Optional gasketing and tamper proofing on request.
- ♦ Finish—All steel housing parts are painted after fabrication with a white powder coating to provide a durable and long lasting finish with a reflectivity of 90% or greater.

PROJECT \_\_\_\_\_

TYPE \_\_\_\_\_

QTY. \_\_\_\_\_

### APPLICATIONS

- ♦ Commercial locations
- ♦ Retail Locations
- ♦ Public Buildings
- ♦ Offices
- ♦ Schools
- ♦ Medical Environments

### INSTALLATION

- ♦ Designed for surface mounting direct to most ceiling types. May be suspended from ceilings on auxiliary hanging hardware. Sufficient knockouts are provided on the back of the housing for all electrical connections. Knockouts on the ends for surface conduit entry on request.

### ELECTRICAL

- ♦ All electrical components are UL or ETL Listed. Lamp holders provided ensure positive lamp retention.
- ♦ Sufficient knock-outs are provided for connections and through wiring.
- ♦ Electronic class P, thermally protected ballasts standard.
- ♦ Green ground screw installed in channel.
- ♦ All fixtures come equipped with ballast disconnect to meet NEC code 410.73.

### APPROVALS

- ♦ ETL Listed. Suitable for dry and damp locations with ETL Damp Label.



### ORDERING GUIDE

Fill in the boxes below with the corresponding **bold** options.

Example: **SM700-24-4-32-T8-B8IN-MV**

SM700						MV				
SERIES	FIXTURE SIZE	NO. OF LAMPS	WATTAGE	LAMP TYPE	BALLAST TYPE	VOLTAGE	OPTIONS			
SM700	T8						EM1	Emergency Battery Back Up, 1 Lamp Operation		
	14   1X4	2	32	T8	B8IN	MV	EM2	Emergency Battery Back Up, 2 Lamp Operation		
	22   2X2	2   3   4	17	T8	B8IN	MV	2C	2 Circuit		
	22   2X2	2	32	U6T8	B8IN	MV	DIM	Dimming—Consult Factory		
	24   2X4	2   3   4	32	T8	B8IN	MV	MS	Motion Sensor		
	T5HO						DG	Double Gasketing		
	14   1X4	2	54	T5HO	B5HOP	MV	Ballast			
	24   2X4	2   3   4	54	T5HO	B5HOP	MV	B8IN	T8, Instant Start NBF (Standard)		
							B5HOP	T5HO, Program Start		
							Voltage			
						MV	120-277V			

Consult Factory for additional configurations and options not listed or shown.

Consult Factory for additional configurations and options not listed or shown.

### DIMENSIONS

2'x2' and 2'x4'

2 Lamps

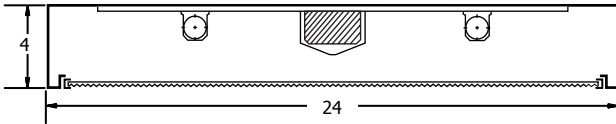

3 Lamps

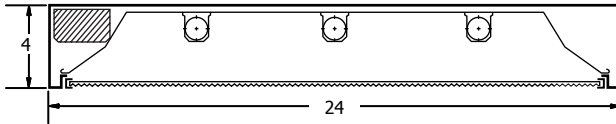

4 Lamps

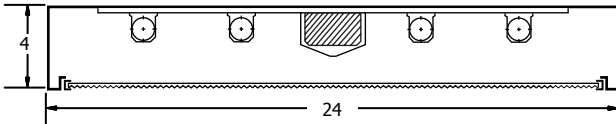

2 U-6 Lamps

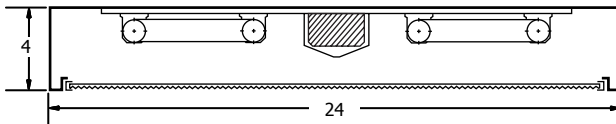

1'x4'

2 Lamps

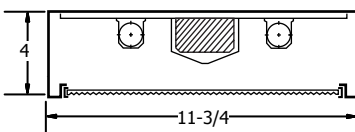

1 Lamp

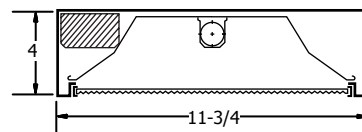

3 Lamps

