



PROJECT _____

TYPE _____

QTY. _____



OVERVIEW

- ♦ An all-purpose 1, 2, or 3 lamps economy strip with pivoting end plates.
- ♦ Available in different lengths -- 2', 3', 4', 6', and 8'.
- ♦ Available in various lamp configurations T12, T12HO, T8, T5, T5HO.
- ♦ Available in 6' and 8' tandem.

CONSTRUCTION

- ♦ Housing—Die formed, heavy gauge cold rolled steel with knockouts for a convenient outlet, a pull chain and conduit.
- ♦ Cover snaps into place eliminating the need for tools when accessing the ballast, fabricated in two sections for 72" and 96" housing to simplify installation.
- ♦ Sides and back have chain hanger slots.
- ♦ Finished with white polyester polymer with a minimum of 82% reflectivity.

APPLICATIONS

- ♦ Industrial
- ♦ Commercial
- ♦ Retail Stores
- ♦ Showcase/Displays
- ♦ Storage
- ♦ Utility Rooms
- ♦ Cove
- ♦ General Area Lighting

INSTALLATION

- ♦ Designed for surface, stem or chain hanging, mounted individually or in continuous row.

ELECTRICAL

- ♦ All electrical components are UL or ETL Listed. Lamp holders provided ensure positive lamp retention.
- ♦ Sufficient knock-outs are provided for connections and through wiring.
- ♦ Electronic class P, thermally protected ballasts standard.
- ♦ Green ground screw installed in channel.
- ♦ All fixtures come equipped with ballast disconnect to meet NEC code 410.73.

APPROVALS

- ♦ ETL Listed. Suitable for dry and damp locations with ETL Damp Label.



ORDERING GUIDE

Fill in the boxes below with the corresponding **bold** options.

Example: **SC100-4-2-32-T8-B8IN-MV**

SC100						MV				
SERIES	FIXTURE LENGTH	NO. OF LAMPS	WATTAGE	LAMP TYPE	BALLAST TYPE	VOLTAGE	OPTIONS			
SC100	T8						EM1	Emergency Battery Back Up, 1 Lamp Operation		
	2 2FT.	1 2 3	17	T8	B8IN	MV	EM2	Emergency Battery Back Up, 2 Lamp Operation		
	3 3FT.	1 2 3	25	T8	B8IN	MV	2C	2 Circuit		
	4 4FT.	1 2 3	32	T8	B8IN	MV	DIM	Dimming—Consult Factory		
	6 6FT.	1 2 3	25-TAN	T8	B8IN	MV	Accessories			
	8 8FT.	1 2 3	32-TAN	T8	B8IN	MV	WG100	Wire-Guard		
	8 8FT.	1 2	59	T8	B8SI	MV	MS	Motion Sensor		
	T5 / T5HO						Note:			
	4 4FT.	1 2 3	28	T5	B5P	MV	TAN—Tandem Units, double the number of lamps			
	8 8FT.	1 2 3	28-TAN	T5	B5P	MV	For T5/T5HO Fixtures—			
	4 4FT.	1 2 3	54	T5HO	B5HOP	MV	T8/T5 Conversion Sockets are used to meet fixture length			
	8 8FT.	1 2 3	54-TAN	T5HO	B5HOP	MV	Ballast			
	T12 / T12HO						B8IN	T8, Instant Start NBF (Standard)		
	6 6FT.	1 2	56	T12	B2SI	MV	B8SI	T8, Instant Start, Slimline		
	8 8FT.	1 2	60 75	T12	B2SI	MV	B2SI	T12, Instant Start, Slimline		
	6 6FT.	1 2	85	T12HO	B2HOR	MV	B5P	T5, Program Start		
	8 8FT.	1 2	110	T12HO	B2HOR	MV	B5HOP	T5 HO, Program Start		
							B2HOR	T12 HO, Rapid Start		
							Voltage			
							MV	120-277V		

Consult Factory for additional configurations and options not listed or shown.

Consult Factory for additional configurations and options not listed or shown.

Note:

TAN—Tandem Units, double the number of lamps

For T5/T5HO Fixtures—

T8/T5 Conversion Sockets are used to meet fixture length

Ballast

B8IN T8, Instant Start NBF (Standard)

B8SI T8, Instant Start, Slimline

B2SI T12, Instant Start, Slimline

B5P T5, Program Start

B5HOP T5 HO, Program Start

B2HOR T12 HO, Rapid Start

Voltage

MV 120-277V

DIMENSIONS

END VIEWS

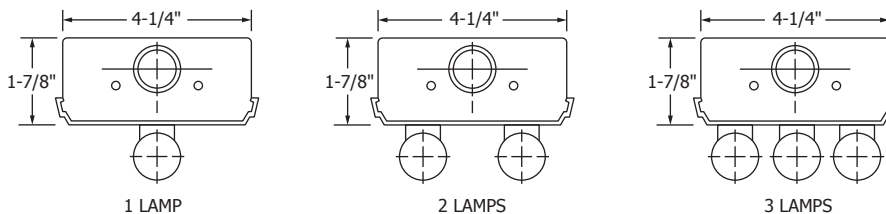

BACK VIEWS

