

LEDREADY



OVERVIEW

- ♦ A bold and sleek luminaire with superior performance. Enclosed and gasketed housing will withstand most critical environments. Weather and chemical resistant, corrosion free, and impervious to vapors, dust, and moisture.

LED TUBES

- ♦ 120-277V (50/60Hz)
- ♦ Rated Life [L70] — 50,000 Hours.
- ♦ Wired for single or double end.
- ♦ Approximately 40% more energy efficient than standard F32T8 Lamps.

Assembled with no ballast

LISTINGS/QUALIFICATIONS

- ♦ Fixture Housing is ETL C/US Listed
- ♦ LED Tubes are ETL or UL C/US Listed and DLC Certified
- ♦ Proudly Made in America
- ♦ IP65, IP66, IP67 Rated
- ♦ NSF Component
- ♦ RoHS Compliant
- ♦ High Pressure Hose Test
- ♦ NEMA 4X



PROJECT _____

TYPE _____

QTY. _____

APPLICATIONS

- ♦ Food Handling and Processing Facilities
- ♦ Refrigerated Storage
- ♦ Drug and Chemical Plants
- ♦ Shower Areas
- ♦ Parking Garages
- ♦ Pedestrian and Roadway Tunnels
- ♦ Outdoor Public Areas

INSTALLATIONS

- ♦ Installations—A 7/8" hole in each end for surface conduit entry and continuous feeds. Liquid tight plugs supplied. Weatherproof hubs supplied by others. Mount individually or continuous. Optional stainless steel "slide grip" style hanger brackets allow easy mounting without drilling housing. Two top-side embossments contain drill points for job site mounting options. Proper sealing will maintain wet location status.

CONSTRUCTION

- ♦ Housing—Molded of one-piece impact resistant fiberglass reinforced polyester; self extinguishing, flame resistant and unaffected by many industrial chemicals
- ♦ Diffuser—One piece injection molded impact resistant linear ribbed acrylic lens.
- ♦ Heavy Gauge Steel-Wiring Tray—Tethered to housing, contains the ballast, sockets, and all wiring on an easy to handle one piece component. Unique metal locking devise system allows tray to hinge open or lock closed for easy one-person wiring connections. Tray is finished in baked white enamel with minimum reflectivity of 87%.
- ♦ Latches—Unbreakable polycarbonate with self-locking feature to stay closed without hardware. Optional tamperproof screws add maximum security against vandalism or unauthorized fixture entry. Stainless steel latches optional.

ORDERING GUIDE

Fill in the boxes below with the corresponding **bold** options.

Example: **LTVT401-2-T8-4-S**

LTVT401	2	T8							
SERIES	NO. OF TUBES	TYPE (LED TUBES)	TANDEM (TAN)	FIXTURE LENGTH	WIRED	OPTIONS			
LTVT401	2	T8	-	4 51" Length	S	Emergency			
	2	T8	TAN	8 100" Length	D	EM5	Emergency Battery Back Up, 500 Lumens - 1 Lamp <i>To operate, must use an electronic instant start ballast</i>		
TANDEM						EM14	Emergency Battery Back Up, 1400 Lumens - 1 Lamp <i>To operate, must use an electronic instant start ballast</i>		
						Sensor			
						M7	Infrared Occupancy On/Off Sensor Weather Proof <i>Externally Mounted</i>		

TANDEM

Tandem Units, use double the number of tubes

CONSULT FACTORY FOR WATTAGE, LUMENS AND COLOR TEMPERATURE.

DIMENSIONS

END VIEW

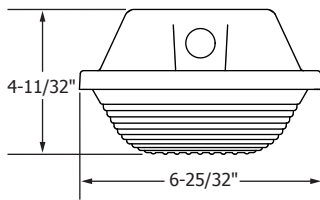

Length	
Nominal	Length
4FT.	51-21/32"
8FT.	100"

TOP VIEW

