

LEDREADY



OVERVIEW

- ♦ Low profile linear luminaire featuring a crystal clear acrylic prismatic diffuser that wraps around the light source.
- ♦ Available in lengths from 24 to 96 inches.
- ♦ Clear, acrylic diffuser with prismatic bottom and ribbed linear sides.
- ♦ Diffuser self-aligns and hinges from either side for easy re-lamping.

LED TUBES

- ♦ 120-277V (50/60Hz)
- ♦ Rated Life [L70] — 50,000 Hours.
- ♦ Wired for single or double end.
- ♦ Approximately 40% more energy efficient than standard F32T8 Lamps.

Assembled with no ballast

LISTINGS/QUALIFICATIONS

- ♦ Fixture Housing is ETL C/US Listed
- ♦ LED Tubes are ETL or UL C/US Listed and DLC Certified
- ♦ Proudly Made in America



PROJECT _____

TYPE _____

QTY. _____

APPLICATIONS

- ♦ Schools
- ♦ Hospitals
- ♦ Office Complexes
- ♦ Retail Locations
- ♦ Commercial Locations

INSTALLATIONS

- ♦ Designed for surface, stem or chain hanging, mounted individually or in continuous row.

CONSTRUCTION

- ♦ Housing—Fabricated from code grade cold rolled steel with ample bends for uniformity and strength. Design embossed end plates are riveted onto housing. Wireway cover snaps into housing for easy maintenance. Finished with a high quality white enamel paint baked on to provide an 87% minimum reflectivity.
- ♦ Diffusers—Extruded from 100% clear virgin acrylic plastic with an evenly spaced pattern of conical prisms on the bottom panel and sharp linear prisms on the interior side panels. Provides optimum brightness control and light transmission. Diffusers hinge down from either side for easy maintenance. All 8Ft. modules use two individual 4Ft. diffusers.
- ♦ Optional Diffusers—A .125" thick version of the standard diffuser or an acrylic smooth white version without prisms.
- ♦ Reflectors—Optical reflectors are CAD designed for optimal reflective performance.

ORDERING GUIDE

Fill in the boxes below with the corresponding **bold** options.

Example: **LTSM704-2-T8-4-S**

LTSM704		T8							
SERIES	NO. OF TUBES	TYPE (LED TUBES)	TANDEM (TAN)	FIXTURE LENGTH	WIRED	OPTIONS			
LTSM704	2	T8	-	2 24" Length	S Wired for Singled End	Wire Guard			
	2	T8	-	4 48" Length	D Wired for Double End	WGW Wire Guard (24" / 48") *			
	2	T8	TAN	8 96" Length		Emergency			
	2	T8	-	8 96" Length		EM5 Emergency Battery Back Up, 500 Lumens - 1 Lamp <i>To operate, must use an electronic instant start ballast</i>			
	4	T8	-	4 48" Length		EM14 Emergency Battery Back Up, 1400 Lumens - 1 Lamp <i>To operate, must use an electronic instant start ballast</i>			
						Sensor			
						M1 Infrared Occupancy On/Off Sensor, Externally Mounted			
						M8 Infrared Occupancy Bi-Level Sensor, Externally Mounted			
						Dimming Systems			
						DLT2 Dimmable Systems Including driver and LED tubes (1 or 2 LED Tubes) 24" Length (Keystone)			
						DLT4 Dimmable Systems Including driver and LED tubes (1 or 2 LED Tubes) 48" Length (Keystone)			

TANDEM

Tandem Units, use double the number of tubes

CONSULT FACTORY FOR WATTAGE, LUMENS AND COLOR TEMPERATURE.

* WIRE GUARDS

For 96" fixtures, use 2 48" wire guards

Wire-guards can only be used on surface mount applications.

DIMENSIONS

2 Tubes

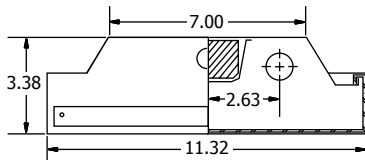

4 Tubes

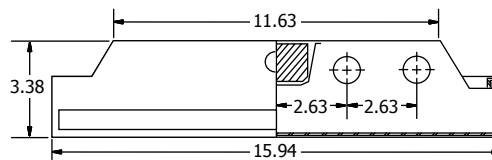

Back Views

