

**LEDREADY**



PROJECT \_\_\_\_\_

TYPE \_\_\_\_\_

QTY. \_\_\_\_\_



**OVERVIEW**

- ♦ General-purpose 2.75" narrow open lamp strip.
- ♦ Available in 1 lamp configurations
- ♦ Available in 2ft., 3ft., and 4ft., 6ft. and 8ft. nominal lengths.

**LED TUBES**

- ♦ 120-277V (50/60Hz)
- ♦ Rated Life [L70] — 50,000 Hours.
- ♦ Wired for single or double end.
- ♦ Approximately 40% more energy efficient than standard F32T8 Lamps.

*Assembled with no ballast*

**LISTINGS/QUALIFICATIONS**

- ♦ Fixture Housing is ETL C/US Listed
- ♦ LED Tubes are ETL or UL C/US Listed and DLC Certified
- ♦ Proudly Made in America



**APPLICATIONS**

- ♦ Commercial
- ♦ Industrial
- ♦ Retail
- ♦ Residential
- ♦ Indirect and Direct Cove/Valence Lighting Areas

**INSTALLATION**

- ♦ Suitable for individual or continuous row mounting. May be surface mounted or suspended on stems, cables, or rods.

**CONSTRUCTION**

- ♦ Housing—Die formed from code gauge cold rolled steel. End plates quickly convert to snap-in continuous row joiners for uninterrupted wireway. Easy install socket plates have snap-in action. Wireway covers snap on or off for easy installation and maintenance. Optional screw-down covers for tight coves or added security. Sufficient knockouts are provided on the back and ends for all electrical connections. Baked white enamel finish provides a minimum reflectivity of 87%. Optional 20GA housing is available.
- ♦ Sockets—1/4 twist bi-pin or optional rotary locking type.

### ORDERING GUIDE

Fill in the boxes below with the corresponding **bold** options.

Example: **LTSC105-1-T8-4-S**

LTSC105	1	T8							
SERIES	NO. OF TUBES	TYPE (LED TUBES)	TANDEM (TAN)	FIXTURE LENGTH	WIRED	OPTIONS			
LTSC105	1	T8	-	2   24" Length	S	Wire Guard			
	1	T8	-	3   36" Length	D	WGW	Wire Guard (24" / 36" / 48") *		
	1	T8	-	4   48" Length		Emergency			
	1	T8	TAN	6   72" Length		EM5	Emergency Battery Back Up, 500 Lumens - 1 Lamp <i>To operate, must use an electronic instant start ballast</i>		
	1	T8	TAN	8   96" Length		EM14	Emergency Battery Back Up, 1400 Lumens - 1 Lamp <i>To operate, must use an electronic instant start ballast</i>		
	1	T8	-	8   96" Length		Sensor			

### TANDEM

Tandem Units, use double the number of tubes

**CONSULT FACTORY FOR WATTAGE, LUMENS AND COLOR TEMPERATURE.**

### \* WIRE GUARDS

For 72" fixtures, use 2 36" wire guards

For 96" fixtures, use 2 48" wire guards

### DIMENSIONS

#### END VIEW

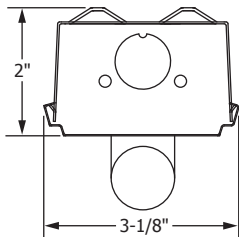

#### BACK VIEWS

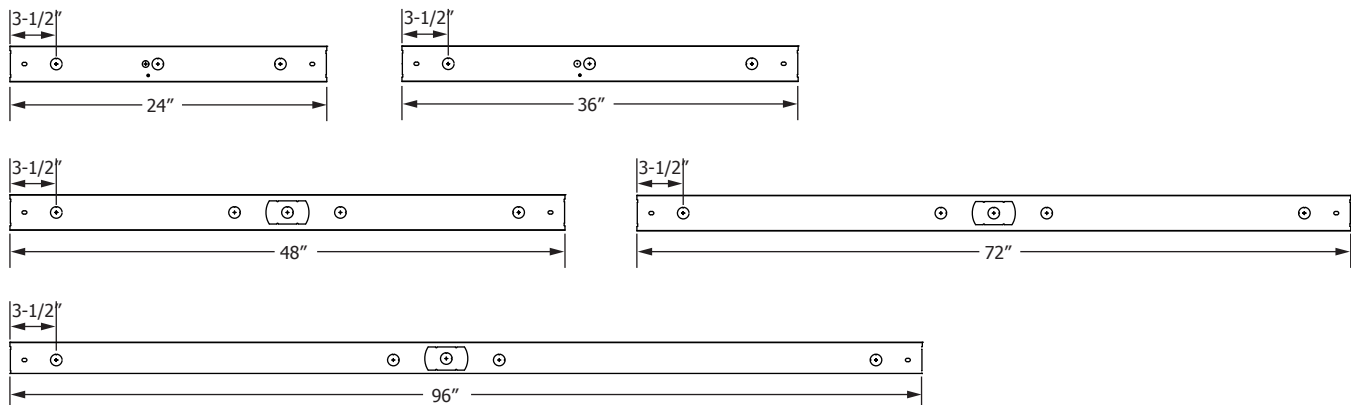

Double KO for easy wiring of the unit, 4ft or larger units.