

LEDREADY



PROJECT _____

TYPE _____

QTY. _____

SHOWN WITH OPTIONAL SENSOR **M1**



OVERVIEW

- ♦ The LTSC100 is a economy open strip linear luminaire.
- ♦ Ideal for conventional fluorescent replacement applications.
- ♦ Available in 2ft., 3ft., 4ft., 6ft. and 8ft. nominal lengths.

LED TUBES

- ♦ 120-277V (50/60Hz)
- ♦ Rated Life [L70] — 50,000 Hours.
- ♦ Wired for single or double end.
- ♦ Approximately 40% more energy efficient than standard F32T8 Lamps.

Assembled with no ballast

LISTINGS/QUALIFICATIONS

- ♦ Fixture Housing is ETL C/US Listed
- ♦ LED Tubes are ETL or UL C/US Listed and DLC Certified
- ♦ Proudly Made in America



APPLICATIONS

- ♦ Coves
- ♦ Industrial Racks
- ♦ Workshops
- ♦ Retail Shelving
- ♦ Utility Areas
- ♦ Warehouses

INSTALLATIONS

- ♦ Designed for surface, stem or chain hanging, mounted individually or in continuous row.

CONSTRUCTION

- ♦ Housing—Die formed, heavy gauged cold rolled steel with knockouts for a convenient outlet, a pull chain and conduit.
- ♦ Cover snaps into place eliminating the need for tools when accessing the ballast, fabricated in two sections for 72" and 96" housing to simplify installation.
- ♦ Sides and back have chain hanger slots.
- ♦ Finished with white polyester polymer with a minimum of 82% reflectivity.

ORDERING GUIDE

Fill in the boxes below with the corresponding **bold** options.

Example: **LTSC100-2-T8-4-S**

LTSC100	2	T8							
SERIES	NO. OF TUBES	TYPE (LED TUBES)	TANDEM (TAN)	FIXTURE LENGTH	WIRED	OPTIONS			
LTSC100	2	T8	-	2 24" Length	S	Wire Guard			
	2	T8	-	3 36" Length	D	WGW			Wire Guard (24" / 36" / 48") *
	2	T8	-	4 48" Length		Emergency			
	2	T8	TAN	6 72" Length		EM5	Emergency Battery Back Up, 500 Lumens - 1 Lamp <i>To operate, must use an electronic instant start ballast</i>		
	2	T8	TAN	8 96" Length		EM14	Emergency Battery Back Up, 1400 Lumens - 1 Lamp <i>To operate, must use an electronic instant start ballast</i>		
	2	T8	-	8 96" Length		Sensor			

TANDEM

Tandem Units, use double the number of tubes

CONSULT FACTORY FOR WATTAGE, LUMENS AND COLOR TEMPERATURE.

* WIRE GUARDS

For 72" fixtures, use 2 36" wire guards

For 96" fixtures, use 2 48" wire guards

DIMENSIONS

END VIEWS

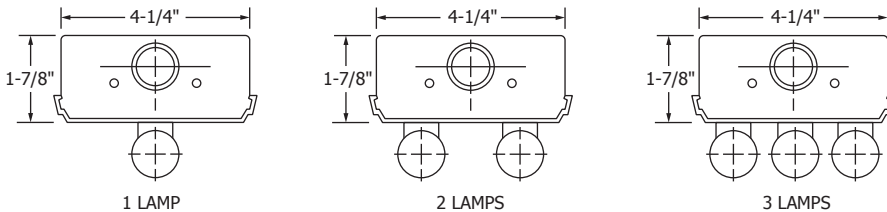

BACK VIEWS

